

Operating Instructions

DUSTY ZIRKON



Dear Customer!

The REITEL extraction units of the DUSTY-Series are used for any kind of dust removal at workplaces or machines in production, in laboratories and in the workshop. They combine solid design with high suction performance. The DUSTY ZIRKON (wet and dry extractor with power tool socket) offers suction power control, allowing precise adaptation of the suction power for different cleaning tasks and silent operation. The DUSTY ZIRKON meets the standard for clean room operation. It is equipped with a motor cooling filter for fine dust and a Push & Clean filter cleaning system.

Prior to installation of the device operating instructions and especially the safety instructions must be read and followed by all personnel who use this device.

After having unpacked the device, please check carefully whether transportation damages of any kind have occurred. If that is the case, the carrier or manufacturer must be notified within 3 days. The company will **not** be responsible for any damages found after that.

These operating instructions must be read and followed by all personnel who use this device. To ensure quick access we recommend to keep it at a safe place near the device. In case of loss it can be ordered at a nominal fee from the manufacturer.

INDEX

1	EQUIPMENT	4
1.1	BASIC EQUIPMENT.....	4
1.2	SPECIAL ACCESSORIES.....	4
1.3	OPERATING ELEMENTS	5
1.4	TECHNICAL DATA	9
2	SAFETY NOTES	10
2.1	GENERAL SAFETY NOTES	10
2.2	SPECIFIC SAFETY NOTES.....	11
3	OPERATION	12
3.1	INSTALLATION.....	12
3.2	HOSE INSTALLATION	12
3.3	FILTER INSTALLATION	12
3.4	CONNECTION OF POWER TOOLS	12
4	NOTES FOR THE USER.....	13
4.1	OPERATION.....	13
4.2	REPLACING FILTER BAG OR FILTER ELEMENT	14
4.3	AUTO CLEAN FUNCTION	14
4.4	PICKING UP DRY SUBSTANCES	14
4.5	PICKING UP LIQUIDS.....	14
4.6	EMPTYING THE DIRT TANK AFTER PICKING UP LIQUIDS	15
5	TROUBLESHOOTING	16
6	MAINTENANCE	17
7	WARRANTY.....	18
8	DISPOSAL REGULATIONS	21
9	SPARE PARTS LIST	22
10	EU DIRECTIVE	23

1 Equipment

1.1 Basic Equipment

- DUSTY ZIRKON single workplace extraction unit with preassembled filter element
- 5,0 m extraction hose
- 7,5 m cable
- Filter bag (1 piece)
- 2 separate handles
- Strap

1.2 Special Accessories

- Order-No.: 27806000 Filter bags DUSTY ZIRKON

1.3 Operating elements

- 1 Handle
- 2 Accessory positions
- 3 Latch
- 4 Castor
- 5 Container
- 6 Inlet fitting
- 7 Switch
- 8 Speed control
- 9 Appliance socket
- 10 Hose hook
- 11 Hose diameter setting
- 12 LED indicator
- 13 Inlet cap

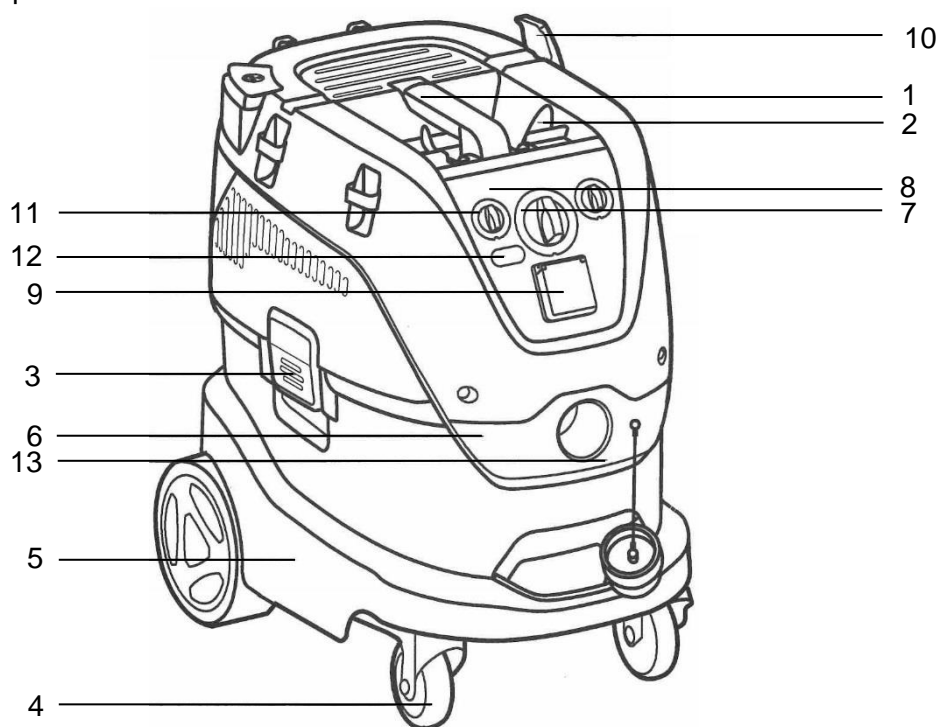
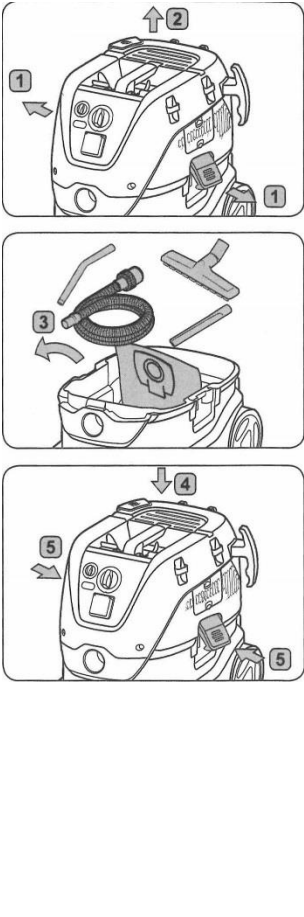

Fig.: Device view

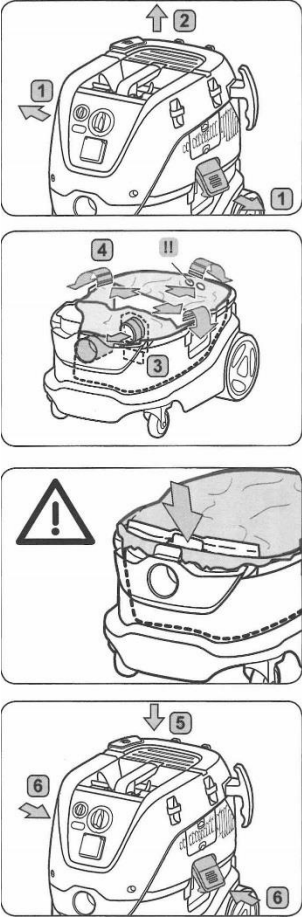

Fig.: Control panel

Detail 1:
Open / close device



Detail 2:
Safety filter bag installation



Detail 3:
Hose insert & operations

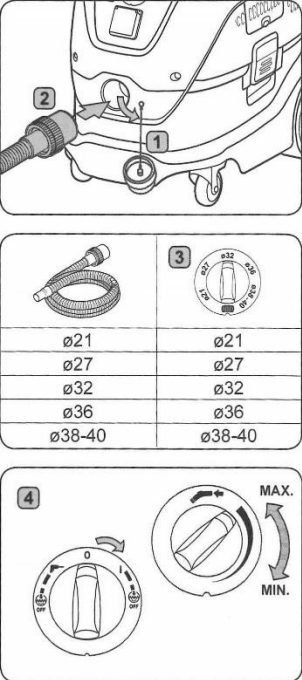

Detail 4:
LED indicator:
flow rate & filter warning



Detail 5:

AutoClean filter cleaning system

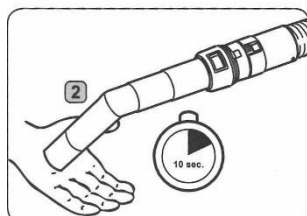
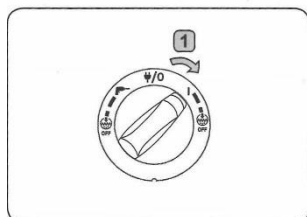
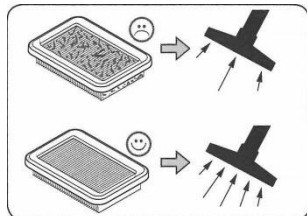

Detail 6:

Power tool adaption

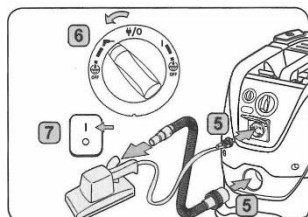
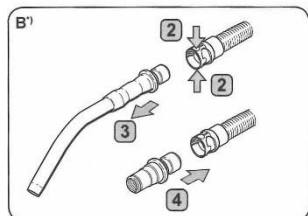
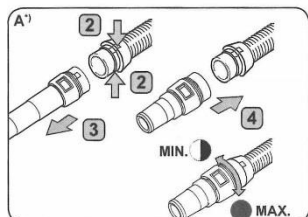
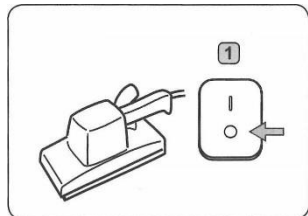

Detail 7:

Safety filter bag replacement

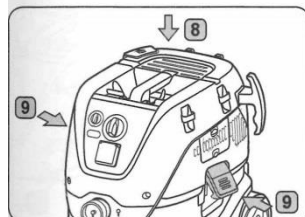
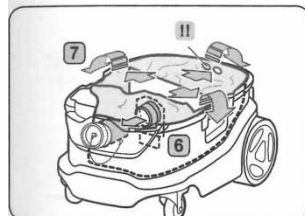
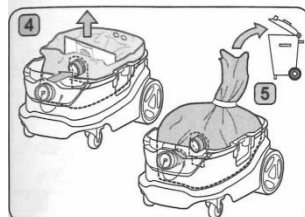
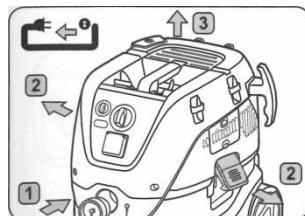

Detail 8:

Filter replacement Dust Class M & H

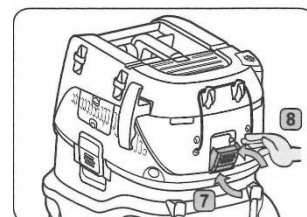
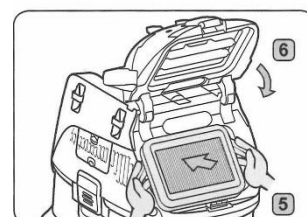
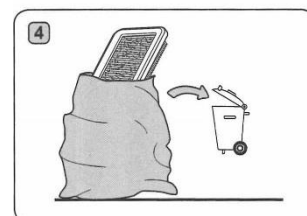
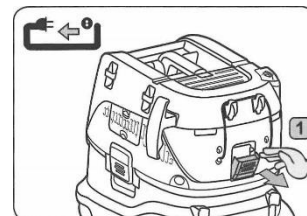

Detail 9:

Essential filter replacement Dust Class H

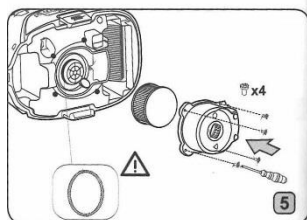
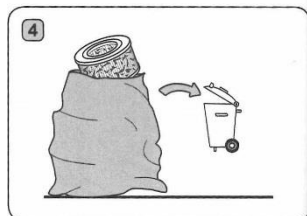
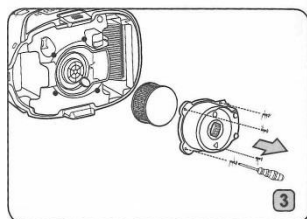
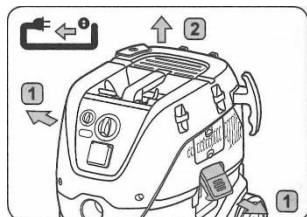

Detail 10:

Motor cooling air diffuser cleaning

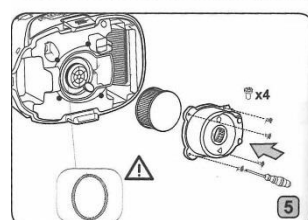
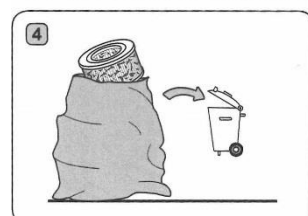
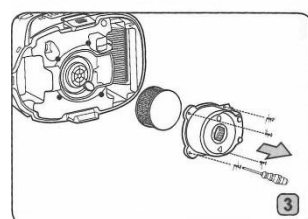
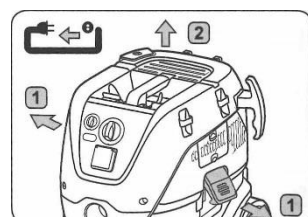

Detail 11:

Gaskets and floater cleaning

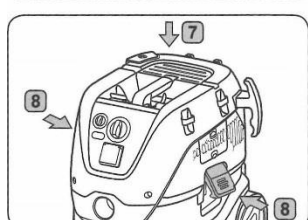
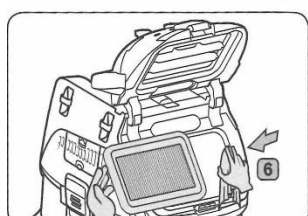
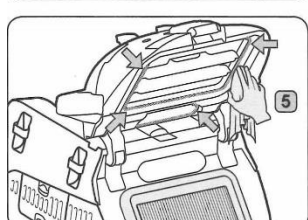
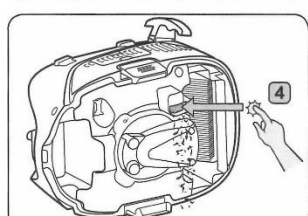
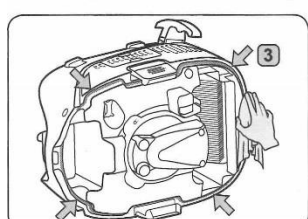
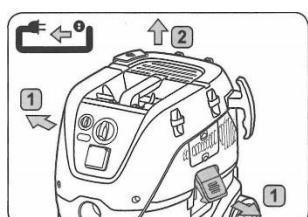

1.4 Technical data

Line voltage	230 V/50–60 Hz
Current consumption	1.200 W
Connected load for appliance socket	2.400 W
Air flow rate	4500 l/min
Height / width / depth	565 / 385 / 605 mm
Weight	16 kg
Dust collection	99,99 % (class H)
Sound level	60 db[A]
Tank volume	42 l
Housing	plastic material
Made in Germany (Subject to modifications)	

2 Safety Notes

2.1 General Safety Notes

- All equipment undergoes final inspection and testing before leaving our factory. However, if equipment is damaged during shipping or through any other circumstances, it must not be used in service. Please check the device regularly for damages. Damaged parts should be replaced immediately.
- All power/air/water/gas sources should be rated for the demands of the device as listed in the technical data sheets. Maximum ratings must not be exceeded. All VDE (Verein Deutscher Elektro-Ingenieure) standards should be followed. Equipment should be grounded according to standards.
- Adherence to valid regulations regarding necessary checks (e.g. according to Accident Prevention & Insurance or electrical equipment) is exclusively taken over by the buyer/user of this product.
- This device has been designated to be used only for its intended purpose. All other applications must be prohibited for safety reasons as otherwise the manufacturer's warranty expires.
- The device should be set-up in a clean, well-ventilated room, if necessary under a hood.
- Supporting surfaces should be straight, flat and adequately stable.
- Don't place anything on top of the machine.
- To avoid injury, appropriate protection should be worn (e.g. gloves, safety glasses, safety shoes, hearing protection etc.)
- If the machine is defective or working improperly it must be taken out of service. In case of further use of the machine the owner will be held responsible for any consequential damage.
- To prevent accidents from water, fire or explosion, all power/air/water/gas sources should be turned off after working hours and during breaks, and secured against unauthorized access.
- When carrying out maintenance works or repairs or when opening the device always turn off the main power switch and unplug the whole unit.
- Repairs should be carried out only by the manufacturer or by qualified and certified personnel appointed according to chapter 7 – warranty.
- In case of leaking water out of housing or tank shut down device and call service.

2.2 Specific Safety Notes

- Don't pick up any explosive, burnable or aggressive fluids or dust with the extraction unit.
- This extraction unit is not suitable for picking up harmful dust, risking to damage the filter element (e.g. glass splinters, metal etc.).
- This machine is not suitable for continuous operation.
- Always turn the machine off and unplug it before carrying out any maintenance work or cleaning.
- Use accessories provided for filling and / or maintenance.
- Don't perform any other maintenance work than listed in the operating instructions. Any operation not listed in the operating instructions may bear risks.
- Before plugging the power tool plug into the socket, ensure that the voltage shown on the rating plate corresponds to the voltage of the local mains power supply.
- Prior to picking up liquids the filter bag must be removed and the float lever needs to be checked. A sieve filter and a filter element must always be installed in the device.
- If foam appears after picking up liquids the device has to be switched off immediately and the dirt tank has to be emptied.
- Don't use the wet filter element for dry dust extraction in order to avoid filter clogging.
- Don't tilt or transport the machine in a lying position if there is liquid in the tank..
- Always insert a filter bag prior to picking up dry substances.
- Do not damage the mains power lead (e.g. by driving over it, pulling or crushing it).
- Using an extension cable the minimum cross-sections must be in compliance with requirements (up to 20 m → 1,5 mm²; 20 bis 50 m → 2,5 mm²).

3 Operation

The equipment delivered is ready for immediate use. The sealed plug can be connected directly to the mains supply 230 V/16 A. For installation please refer to safety notes in chapter 2.

3.1 Installation

1. Ensure that the cleaner is switched off. Turn switch (7) to position "0" (off).
2. Check if a suitable filter is inserted in the device.
3. Insert the power cord into a properly installed and fused socket with earthing contact.

3.2 Hose Installation

1. Connect the supplied extraction hose to the latch (3).
2. The hose diameter must match the hose diameter setting (11).
3. Check the extraction hose for a tight fit.

3.3 Filter Installation

1. Open the retaining clamps and remove the upper section of the vacuum cleaner (s. p. 6 – detail 2).
2. Press the filter bag connection firmly on to the inlet fitting in the dirt tank (s. p. 7 – detail 7).
3. Attach the upper section of the vacuum cleaner. Close the retaining clamps (3). Ensure that the retaining clamps fit properly (s. p. 6 – detail 1).

3.4 Connection of power tools

Attention:

To comply with regulations, only approved dust producing tools should be connected. The maximum power consumption of the connected electrical appliance is stated in „Trouble-shooting“, chapter 5 and „Technical Data“. The operating instructions incl. safety instructions for the connected tool have to be adhered to.

1. Connect the extraction unit to a power tool (s. p. 7 – detail 6):
 - a. The extraction must be switched off (7).
 - b. Switch off the power tool.
 - c. Attach the end of the supplied extraction hose to the extraction connection sleeve on the power tool.
 - d. Insert the plug of the extraction into the device socket of the power tool and connect it to the mains supply 230 V/16 A.

2. Connect a power tool to the extraction unit:

- a. The extraction must be switched off (7).
- b. Switch off the power tool.
- c. Attach the end of the supplied extraction hose to the extraction connection sleeve on the power tool.
- d. Insert the plug from the power tool into the accessory socket (9) on the extraction control panel and connect it to the mains supply 230 V/16 A.

4 Notes for the User

The DUSTY ZIRKON is suitable for picking up liquids and dry substances. Using both filter element and filter bag, high level filtration is achieved for picking up dry substances. For picking up liquids please refer to chapter 4.5.

4.1 Operation

1. Extraction unit without connected tool:

- a. Switch on the extractor with switch (7) to "I"
- b. Turn the speed control (8) clockwise to regulate suction power.
- c. Switch off the extractor with switch (7) to "0"

2. Connected power tool activated by extraction unit:

- a. Make sure that both devices are turned off first.
- b. Switch on the power tool
- c. Switch on the extraction counterclockwise with the switch (7) to "auto" – the power tool also starts.
- d. Turn the speed control (8) clockwise to regulate suction power.
- e. When switching off extractor with switch (7) to "0", the external device also stops.

3. Extraction unit activated by power tool:

- a. Make sure that both devices are turned off first.
- b. Switch on extractor with the clockwise switch (7) to "I"
- c. When switching on the power tool, the extractor starts automatically
- d. Turn the speed control (8) clockwise to regulate suction power.
- e. When switching off the power tool, the extractor stops automatically. The extraction unit continues to run for a short moment.
- f. When work is finished switch off the extraction unit by turning the switch (7) to „0“

4. Extraction as extension cable:: Switch (7) to „0“

4.2 Replacing filter bag or filter element

1. Open the retaining clamps and remove the upper section of the vacuum cleaner.
2. Carefully remove the filter bag connection from the inlet fitting and insert a new filter bag in the dirt tank. Press the bush of the new filter bag firmly on to the inlet fitting (dispose of the filter bag in accordance with legal regulations).
3. Turn the filter holder anticlockwise and remove the filter element. Dispose of the used filter element in accordance with legal regulations. Insert the new filter element. Fit the filter holder and turn it clockwise to secure it.
4. Clean the rim of the tank and the seals in the intermediate ring and the upper section of the cleaner before refitting them. Close the retaining clamps.

4.3 AutoClean function

The extraction unit is equipped with an automatic filter cleaning system. A frequent cleaning cycle will automatically run during operation to ensure that suction performance is always at its best. If suction performance decreases, a manually filter cleaning operation is recommended:

1. Turn the switch (7) to position „I“ and let the machine operate at full speed (8).
2. Close the extraction hose opening with the palm of your hand for approx. 10 seconds.
3. If suction power is still reduced take out the filter and clean mechanically or replace filter.

For certain operations it is recommended to turn off the AutoClean function by turning the switch (7) to the respective stop position.

4.4 Picking up dry substances

The appliance is equipped with a pre-installed filter element. Before picking up dry substances, always ensure that a filter bag is inserted in the tank. After picking up liquids, the filter element is wet. A damp filter element clogs more quickly when dry substances are picked up. For this reason the filter element should be washed and dried or replaced by a dry element before dry substances are picked up.

4.5 Picking up liquids

Before liquids are picked up, always remove the filter bag. If foam appears, stop work immediately and empty the tank.

1. Open the retaining clamps and remove the upper section of the extraction unit.
2. Turn the filter holder anticlockwise and remove it. Insert a separate filter element for picking up liquids. Fit the filter holder and turn it clockwise to secure it.
3. Remove the used filter bag.

4.6 Emptying the dirt tank after picking up liquids

1. Open the retaining clamps and remove the upper section of the vacuum cleaner.
2. Tip out the collected dirt and dispose of the dirt in accordance with legal regulations.
3. Clean the rim of the tank and the seals in the intermediate ring and the upper section of cleaner, before refitting them. If the seal or groove is dirty or damaged, the suction performance will be reduced. Close the retaining clamps.

5 Troubleshooting

Device cannot be switched on (motor doesn't start).	<ul style="list-style-type: none"> a. Check the building's fuse. b. Overload protection switch has tripped (Switch off the extraction unit and allow it to cool for approx. 5 minutes)
Motor does not run in automatic mode.	<ul style="list-style-type: none"> a. Power tool is defective or not connected properly → check that the power tool works or that the plug is inserted correctly. b. The power rating of the electrical tool is too low → note that minimum power rating is $P > 40 \text{ W}$.
Reduced suction power.	<ul style="list-style-type: none"> a. Check suction power control. b. Clogged suction hose/nozzle → clean extraction hose/nozzle. c. Seal between tank and upper section of vacuum cleaner is dirty → clean gasket. d. Full filter bag → replace it. e. Filter element is clogged → clean filter element or replace it. f. Full dirt tank → Switch off the extraction unit and empty the tank.

6 Maintenance

- Regularly check the device for visible damage to housing or power cord.
- Regularly replace the filter bag (see chapter 4.2 Replacing filter bag or filter element).
- Regularly clean or replace the filter element (see chapter 4.2 replacement of filter bag or filter element).
- Regularly empty and clean the dirt tank (see chapter 4.6), especially if the extraction unit has not been used for some time.
- After picking-up liquids: store the upper section of the vacuum cleaner separately so that the filter element can dry.
- Regularly clean the housing with a damp cloth.

7 Warranty

We, REITEL Feinwerktechnik GmbH, offer a 1 year's warranty beginning from the proven date of purchase. This warranty covers all defects traceable to materials, design or workmanship. The following warranty regulations are applicable:

Within the warranty period Reitel Feinwerktechnik GmbH or an authorised distributor agrees at its sole option, to perform repair or replace this product at no charge covering all defects traceable to materials, design or workmanship. Warranty only applies to appropriate use and regular maintenance of this product according to the operating instructions. Claims under warranty are restricted to complementary performance. Additional claims, especially claims for indemnifications, are not covered by this warranty.

1.

Warranty claims have to be addressed to the distributor the product was purchased from or directly to our service department.

Contact:

REITEL Feinwerktechnik GmbH

Senfdamm 20

49152 Bad Essen

Germany

Phone: +49(0)5472-9432-32 (Service Department)

Phone: +49(0)5472-9432-0 (Reception)

Fax-No: +49(0)5472-9432-40

2.

In case of warranty claim application the sales receipt or your purchase invoice showing the date of purchase of the product and the serial number must be furnished. Securely pack and ship the device, freight charges prepaid, at your own risk to us, along with a report describing the defect. We reserve the right to decline warranty if this information has been removed or modified after purchase of the product or if they are not included in case of warranty claims.

3.

Warranty repairs have to be performed by REITEL Feinwerktechnik GmbH or by authorised distributors. Repairs performed by non-authorised companies will void the claim for refund since damages to the product resulting hereof are not covered by warranty.

4.

If the unit sent in for repair or replacement is still under the original warranty then warranty is to the end of the original 1 year warranty.

5.

If the unit is destined to be operated in another country than originally intended and manufactured for, modifications to the product might be necessary to comply to special technical and /or safety standards of that specific country. Such modifications are no defects traceable to materials, design or workmanship. and are therefore expressly excluded from warranty claims.

Modification costs or damages arising from operation of the product under deviating conditions are not covered by warranty.

6.

Exclusions from warranty:

- Service and maintenance work as well as repair and replacement of consumables according to our consumables' list
- Transportation cost of the machine or installation and dismounting expenses incurred
- Damages due to use of the product other than for its intended purpose
- Damages due to faulty installation or insufficient maintenance of the product (e.g. decalcification)
- Damages due to natural disaster e.g. lightning, water, fire, act of nature beyond control, war, inadequate line voltage, insufficient ventilation, no decalcification, insufficient care and cleaning or non-adherence to operation and maintenance instructions according to the accompanying operation guide.
- Damage due to use of the product other than in accordance with the instructions provided by REITEL Feinwerktechnik GmbH;
- The warranty does not cover the cost of removal and replacement of parts and accessories, unless supplied as original equipment by REITEL Feinwerktechnik GmbH
- All kind of damages occurred not directly at the device as well as consequential damages (e.g. damages to furniture due to a lack of water, downtime of the machine, material, lost working hours, wages and other consequential damages).

This warranty shall be rendered null and void if:

- the product has been subject to any modification, repair or replacement other than as authorised by REITEL Feinwerktechnik GmbH
- the product is continued to be operated despite a functional defect

7.

The warranty is device specific and may be claimed, within the warranty period, by any person who has legally acquired the device.

8.

Consumables are excluded from warranty. Spare parts are subject to a warranty coverage of 6 months against all defects traceable to materials, design or workmanship according to these warranty regulations.

9.

Legal default claims on the part of the purchaser remain unaffected by this warranty.

10.

We reserve the right to charge a fee if repair of the device is rejected and the device is destined to be sent back unrepaired.

11.

Please note:

Upon repair or replacement of this unit, personal data and settings might get lost or damaged. We don't accept liability for all kind of data loss. The customer is advised to backup essential programs and data before sending for service.

12.

This warranty shall be interpreted in accordance with German law to the exclusion of UN sales law. Place of jurisdiction is our business location.

13.

If any provisions of this warranty are judged to be illegal or unenforceable, the continuation in full force and effect of the remaining provisions will not be prejudiced. The provisions of this warranty judged to be illegal or unenforceable shall be construed so as to give effect to the intent manifested by the provision held invalid, illegal or unenforceable and to give effect to section 13 hereof.

14.

Should you need to borrow a device while your device is being repaired, please contact Messrs. REITEL or your distributor. These loans are a service for which availability cannot necessarily be guaranteed. After the warranty period, a fee may be charged for loan equipment as well as for shipping and packaging.

8 Disposal Regulations



According to valid laws our devices are properly disposed of according to B2B-regulations for proper disposal. Pls. contact your local dealer for additional information.

9 Spare parts list

Best.-Nr.: Ref.:		Menge Qty.	ME Unit
	Absaugschlauch, 5 m Extraction hose, 5 m	1	Stck piece

10 EU DIRECTIVE

EU-Konformitätserklärung EC-Conformity Declaration CE-Déclaration de Conformité

im Sinne der EG-Richtlinie 2006/42/EG über Maschinen (Anhang II A)
according to Machinery Directive 2006/42/EC (Appendix II A)
au sens de la Directive Machines 2006/42/CE (Annexes II A)

Name und Anschrift des Herstellers/Name and address of manufacturer/Nom et adresse du fabricant:

Reitel Feinwerktechnik GmbH
Senfdamm 20
49152 Bad Essen

Diese Erklärung bezieht sich nur auf die Maschine in dem Zustand, in dem sie in Verkehr gebracht wurde; vom Endnutzer nachträglich angebrachte Teile und/oder nachträglich vorgenommene Eingriffe bleiben unberücksichtigt. Die Erklärung verliert ihre Gültigkeit, wenn das Produkt ohne Zustimmung umgebaut oder verändert wird./This declaration relates exclusively to the machinery in the state in which it was placed on the market and excludes components which are added and/or operations carried out subsequently by the final user. This declaration will become invalid if any unauthorised modification is made to the product./Cette déclaration concerne exclusivement les machines dans l'état dans lequel elles ont été mises sur le marché et exclut des composants ajoutés et/ou les opérations effectuées par la suite par l'utilisateur final. La présente déclaration perd sa validité si des modifications non-autorisées ont été apportées à la machine.

Hiermit erklären wir, dass die nachstehend beschriebene Maschine/**We hereby declare** that the machine described below/**Nous déclarons** que la machine ci-dessous

Produktbezeichnung/Product name/Nom du produit: **Absaugung/
Suction/
Aspiration**

Typenbezeichnung/Type/Type: DUSTY MINI / COMFORT / ZIRKON

allen einschlägigen Bestimmungen der Maschinenrichtlinie 2006/42/EG sowie der Richtlinie 2014/30/EU (EMV-Richtlinie) über elektromagnetische Verträglichkeit entspricht. Die Schutzziele der Richtlinie 2014/35/EU über elektrische Betriebsmittel sowie der Richtlinien 2011/65/EU (RoHS 2) werden eingehalten./is in conformity with all applicable requirements of the Machinery Directive 2006/42/EC and the Electromagnetic Compatibility Directive 2014/30/EU. The safety objectives of the Directive on Electrical Equipment 2014/35/EU as well as the Directive 2011/65/EU (RoHS 2) are adhered to./est conforme aux dispositions applicables de la Directive Machines 2006/42/CE et de la Directive Compatibilité Electromagnétique 2014/30/EU. Les objectifs de sécurité de la Directive sur les Matériels Electriques 2014/35/EU ainsi que de directive 2011/65/EU (RoHS 2) sont respectés.

Angewandte harmonisierte Normen/Harmonised standards applied/Normes harmonisées appliquées:

DIN ISO 12100:2011	DIN EN 61010-1:2020
DIN EN 60204-1:2019	EN 61000-6-1:2019
DIN EN 45635-1	EN 61000-6-3:2011

Bevollmächtigter für die Zusammenstellung der relevanten technischen Unterlagen/Representative authorised to compile the relevant technical documentation/Personne autorisée à constituer la documentation technique pertinente:

Daniel Reitel
Reitel Feinwerktechnik GmbH
Senfdamm 20
49152 Bad Essen

11.02.2021

Ort, Datum
Place, Date
Lieu, Date

Daniel Reitel, Geschäftsführender Gesellschafter/Managing Director/
Directeur Général



Unterschrift/Signature/
Signature

We manufacture in compliance with Quality Management ISO 13485:2016 incorporating established standards.



REITEL Feinwerktechnik GmbH
Senfdamm 20 | 49152 Bad Essen
Phone.: +49-(0)5472-9432-0 | Fax: +49-(0)5472-9432-40
www.reitel.com | info@reitел.com